



0 Bed

A1

**located
in Brookmans Park**

£18,000 Per Annum



Duncan Perry
SALES ■ LETTINGS ■ COMMERCIAL

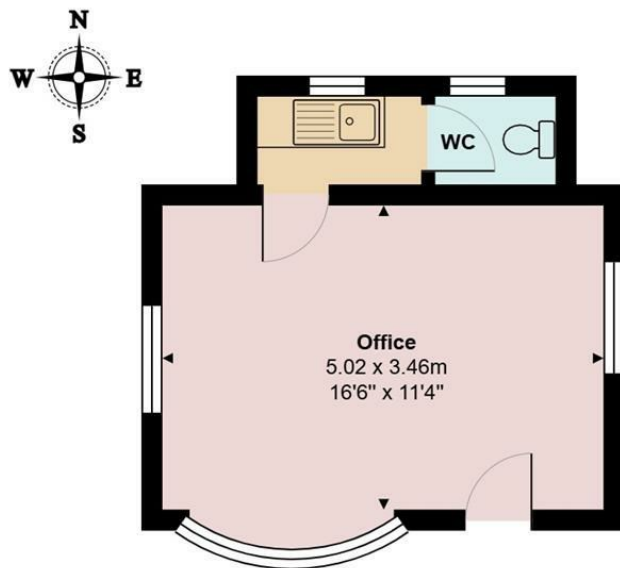

Bradmore Green, Brookmans Park, AL9 7QS

Total Area: 22.3 m² ... 240 ft²

All measurements are approximate and for display purposes only

DIRECTIONS

CONTACT

79 Bradmore Green
Brookmans Park
Herts.
AL9 7QT

E:
T: 01707664549
www.duncanperry.co.uk

Energy Efficiency Rating		
	Current	Potential
Very energy efficient - lower running costs		
(92 plus) A		
(81-91) B		
(69-80) C		
(55-68) D		
(39-54) E		
(21-38) F		
(1-20) G		
Not energy efficient - higher running costs		
England & Wales		
EU Directive 2002/91/EC		

